



Carol A. McKee, President
Sherry R. Huber, 1st Vice President
Rebecca W. Arnold, 2nd Vice President
John S. Franden, Commissioner
Sara M. Baker, Commissioner

To: Property Owners and Interested Parties

March 26, 2009

From: Al Busche - Project Manager

Subject: **2009 Federal Aid Overlays** - ACHD Project # 707035

This letter is to inform you of construction starting in June on the Ada County Highway District's overlay project. Construction should begin on or about June 5, 2009 and is scheduled for completion on or about July 10, 2008. Construction includes rotomilling the surface (removing a layer of the existing road) and overlaying various streets with hot asphalt pavement. Existing sidewalks will be updated with pedestrian ramps at the intersections as needed.

The road segment in your area which will be improved is **Linder Road, Ustick Road to McMillan Road**. Please see the attached vicinity map for your specific location. This particular section will require rotomilling, which can be noisy. The contractor will be allowed to do the work from 8:30am to 4pm and from 6pm to 10pm. There will be lane restrictions during the manhole adjustment, rotomilling and paving phases; with traffic through the work zone controlled by flaggers as necessary for safety. For specific details regarding the construction schedule, contact Steve Sprague, ACHD Construction Services, at 387-6282.

ACHD does not allow cuts in new pavement for a period of five years in order to maintain the integrity of the road and protect the environment. If you have plans to develop property adjacent to this project, or desire to connect a utility (gas, water, sewer, etc.) not presently servicing your parcel, the utility stub outs or connections should be made at this time. Please contact the respective utility for information pertaining to the desired service.

If you own property along the project corridor, but do not live there, please pass this information on to your renter or tenant.

We regret any inconvenience that this work may temporarily cause you, but we are certain the project will result in a smoother, longer lasting roadway, with updated pedestrian ramps at the intersections.

If you have any questions, please call me at 387-6225.

Al Busche, Project Manager
ACHD Capital Projects
387-6230

c:ACHD Director
Engineering Manager
Utility Coordinator
Central & Chron

Deputy Directors
Resident Engineer
Communications

Construction
Right-of-Way
Design

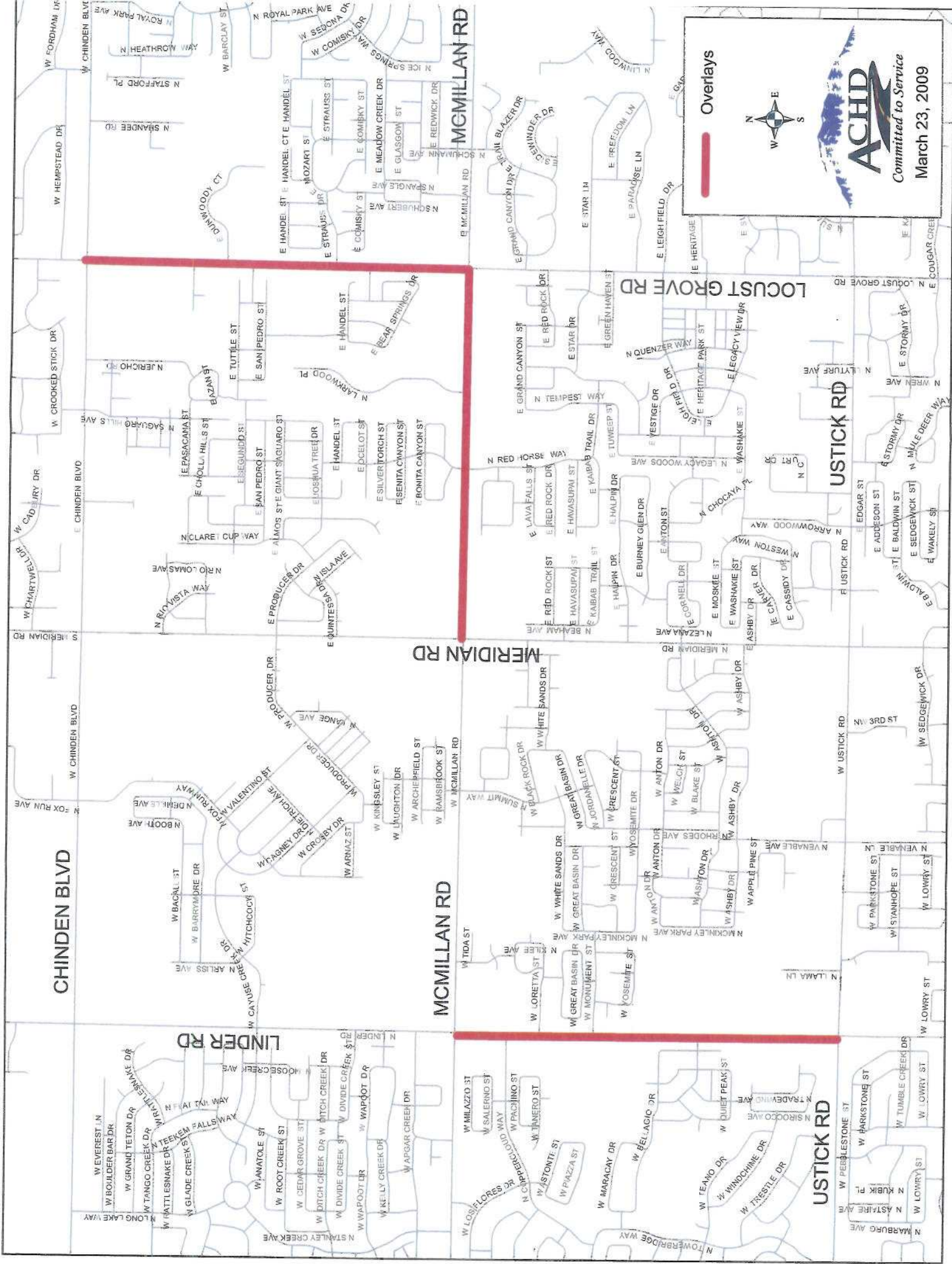

CHINDEN BLVD

LINDER RD

MERIDIAN RD

MCMILLAN RD

MCMILLAN RD

LOCUST GROVE RD

USTICK RD

USTICK RD

Overlays



Committed to Service
March 23, 2009